

Schottky Barrier Rectifiers

Using the Schottky Barrier principle with a Refractory metal capable of high temperature operation metal. The proprietary barrier technology allows for reliable operation up to 150°C junction temperature. Typical application are in switching Mode Power Supplies such as adaptors, charger, DC/DC converters and polarity protection diodes.

Features

- Low Forward Voltage.
- Low Switching noise.
- High Current Capacity.
- Guarantee Reverse Avalanche.
- Guard-Ring for Stress Protection.
- Low Power Loss & High efficiency.
- 150°C Operating Junction Temperature.
- Low Stored Charge Majority Carrier Conduction.
- Flammability Classification 94V-O.
- Lead free in compliance with EU RoHS 2011/65/EU directive.

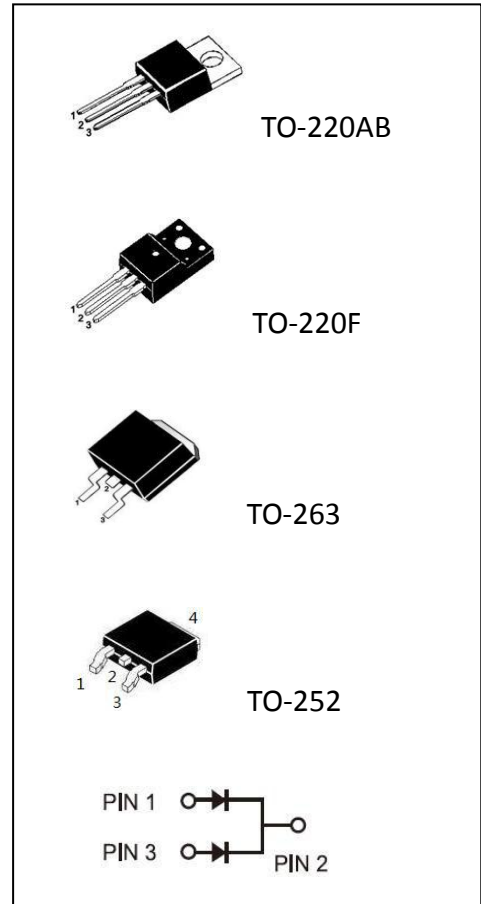

Maximum Ratings (Per Leg) at Ta=25°C unless otherwise specified

Characteristics	Symbol	S20C45	S20C60	Unit
Maximum Repetitive Peak Reverse Voltage Working Peak Reverse Voltage Maximum DC Blocking Voltage	V_{RRM} V_{RWM} V_R	45	60	V
RMS Reverse Voltage	$V_R(RMS)$	32	42	V
Average Rectifier Forward Current (per diode) Total Device (Rated VR), Tc=125°C	I_O	15 30		A
Peak Forward Surge Current, 8.3 ms Single Half Sine-wave	I_{FSM}	200		A
Operating and Storage Temperature Range	TJ, Tstg	-40 to +150		°C
Typical Thermal Resistance junction to case (per device)	Rθj-c	3.5		°C/W

Electrical Characteristics (Per Leg) unless otherwise specified

Characteristics		Symbol	S20C45		S20C60		Unit
Maximum Instantaneous Forward Voltage (per diode) (IF =10 Amp TC = 25°C)		V_F	Type	MAX	Type	MAX	V
			0.53	0.55	0.63	0.65	
Maximum Instantaneous Reverse Current	TA=25°C	I_R	10	50	20	50	μA
	TA=125°C		3	10	1	10	μA

RATING AND CHARACTERISTIC CURVES

FIG-1 FORWARD CURRENT DERATING CURVE

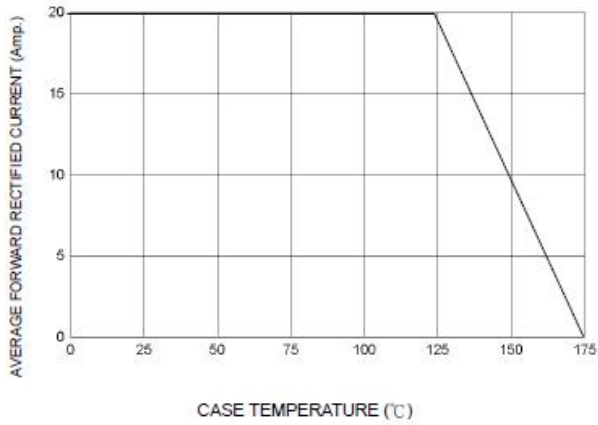

FIG-2 TYPICAL FORWARD CHARACTERISTICS

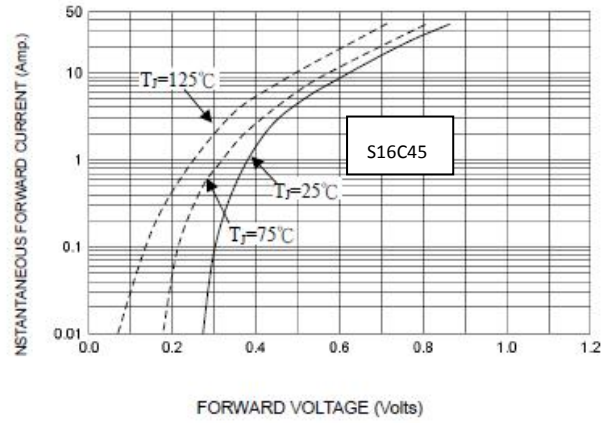

FIG-2 TYPICAL FORWARD CHARACTERISTICS

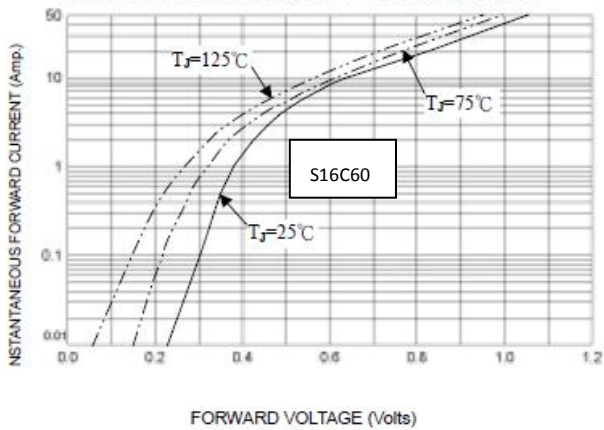

FIG-3 TYPICAL REVERSE CHARACTERISTICS

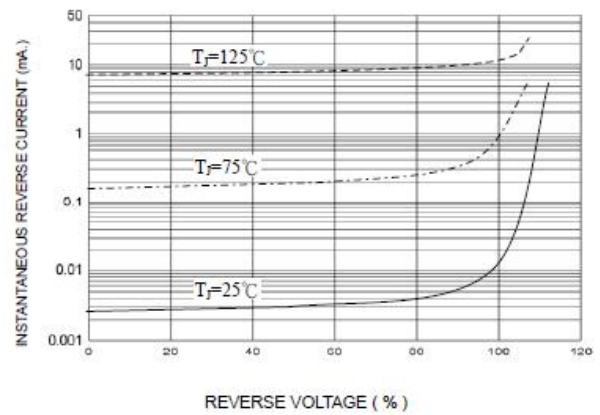

FIG-4 TYPICAL JUNCTION CAPACITANCE

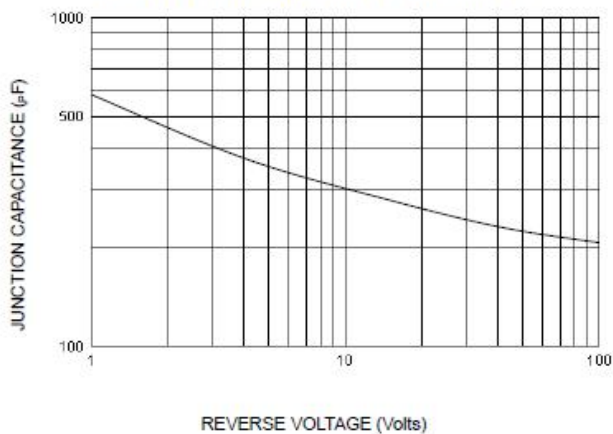
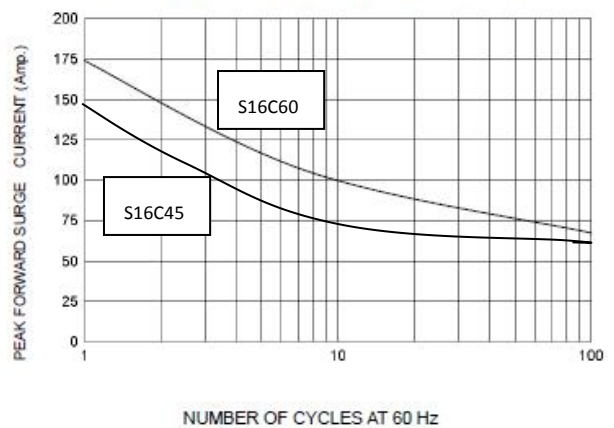
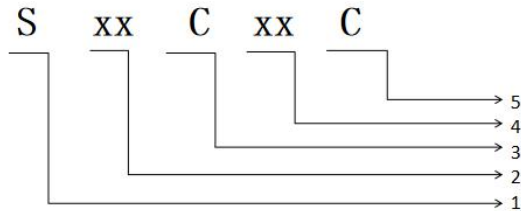

FIG-5 PEAK FORWARD SURGE CURRENT



Marking on the body

Diode tube naming convention



- 1: **S**: Schottky **F**: Recovery
- 2: Rated current(A)
- 3: **C**: GPP Recovery/Schottky
F: fast **U**: Super fast **H**: Super fast
HP: Super fast, PFC diode
- 4: Rated voltage(V)
- 5: Package
C: TO-220AB **F**: TO-220F
A: TO-220AC **P**: TO-220FAC
B: TO-263 **W**: TO-3P/TO-247S

Package Outline Dimensions millimeters

TO-220AB

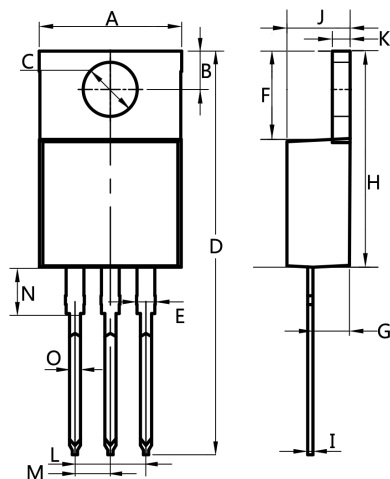

DIM	Min.	Max.
A	10.15	10.35
B	2.65	3.0
C	3.7	3.9
D	28.5	29
E	1.3	1.45
F	6.35	6.55
G	2.9	3.3
H	15.0	16
I	0.38	0.4
J	4.45	4.55
K	1.25	1.35
L	Typ 5.08	
M	Typ 2.54	
N	3.1	3.3
O	0.76	0.84
All Dimensions in millimeter		

TO-220F

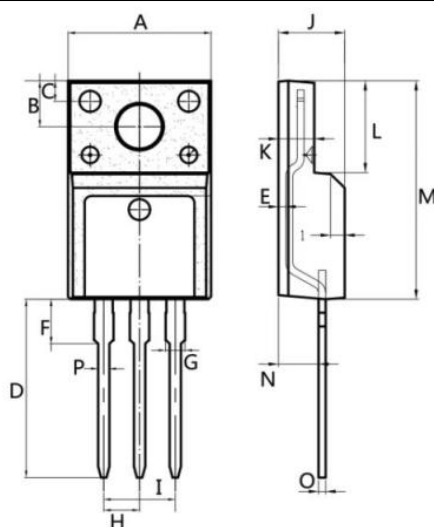

DIM	Min.	Max.
A	9.9	10.3
B	2.9	3.5
C	1.15	1.45
D	12.75	13.45
E	0.55	0.75
F	3.1	3.5
G	1.25	1.45
H	Typ 2.54	
I	Typ 5.08	
J	4.55	4.75
K	2.4	2.7
L	6.35	6.75
M	15.0	16.0
N	2.75	3.15
O	0.45	0.60
P	0.7	0.9
All Dimensions in millimeter		

TO-263

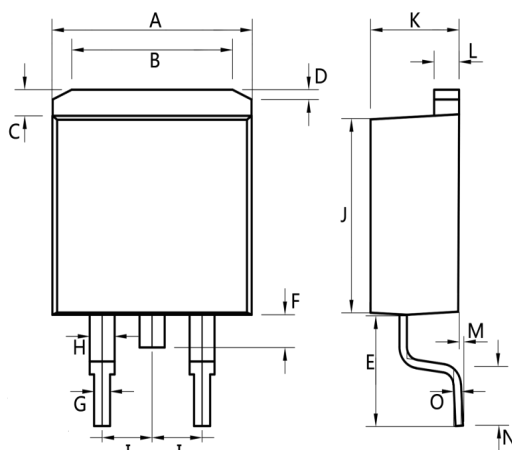

DIM	Min.	Max.
A	10.1	10.2
B	7.4	7.6
C	1.3	1.5
D	0.55	0.75
E	5.0	6.0
F	1.4	1.6
G	0.78	0.86
H	1.2	1.3
I	Typ 2.54	
J	8.4	8.6
K	4.45	4.55
L	1.25	1.35
M	0.02	0.1
N	2.4	2.8
O	0.36	0.4

All Dimensions in millimeter

TO-252

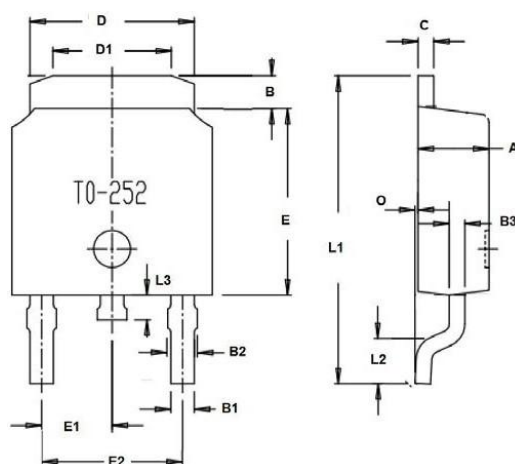

DIM	Min.	Max.
A	2.1	2.5
B	0.95	1.55
C	0.4	0.6
D	6.4	6.7
D1	5.1	5.8
E	5.8	6.4
E1	Typ 2.3	
E2	Typ 4.6	
B1	0.6	0.8
B2	0.75	0.95
O	--	0.15
L1	9.0	11.0
L2	1.3	1.7
L3	0.7	0.95

All Dimensions in millimeter

Statement:

- ◆ We reserve the right to change the manual without prior notice! Customers should obtain the latest version of the information before placing an order, and verify that the relevant information is complete and up-to-date.
- ◆ Any semiconductor product has the possibility of failure or failure under specific conditions. The buyer has the responsibility to comply with safety standards and take safety measures when using Silan product for system design and complete machine manufacturing, so as to avoid the occurrence of personal injury or property loss caused by potential failure risk!
- ◆ Product promotion will never end, our company will wholeheartedly provide customers with more excellent products!